

FR65

FR65



Thermally insulated fire protection system. Structures designed on the basis of the FR65 system feature fire rating EI30.

FR65

Thermally insulated fire protection system. Structures designed on the basis of the FR65 system feature fire rating for walls EI30, EI60 and feature fire rating for doors EI30.

System characteristics:

- installation depth 65 mm
- symmetrically designed profile, middle chamber filled with gypsum infill elements (between thermal separation sheets)
- compatible with systems with the installation depth of system 65 mm (Imperial, Ecofutural)
- possibility of using a double glazing unit (glazing: 17 mm to 48 mm)
- option of panel infill (panel thickness 17 mm):
 - gypsum filled panels
 - the possibility of using steel or aluminum sheet
- application: indoor installations
- structures: single and double doors, fixed glazing
- maximum dimensions of the tested structure: 4930 x 3100 mm (fixed wall)
- maximum dimensions of single-leaf doors: 1450 x 2500 mm
- maximum dimensions of double-leaf doors: 2690 x 2500 mm
- single-point and multi-point door locks, electric door strikes
- cover plate hinges
- solutions with and without thresholds
- door kick plates (high plinth block)
- option of air vent installation
- optimised profiles (one profile type for the door frame and leaf)
- quick and simple prefabrication (no processing of the glazing bar)
- Acoustics – acoustic testing of double-leaf doors featuring fire rating EI30 and EI60 for indoor installations: from 37 dB, gypsum filled panels: 33 dB

Wide range of colours – RAL palette (Qualicoat 1518), texture colours, Aliplast Wood Colour Effect (wood-like colours), Aliplast Loft View – colours imitating stone surfaces (Qualideco PL-0001), anodized colour (Qualanod 1808), bi-colour.

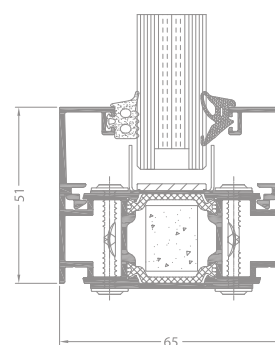

FR65 window section

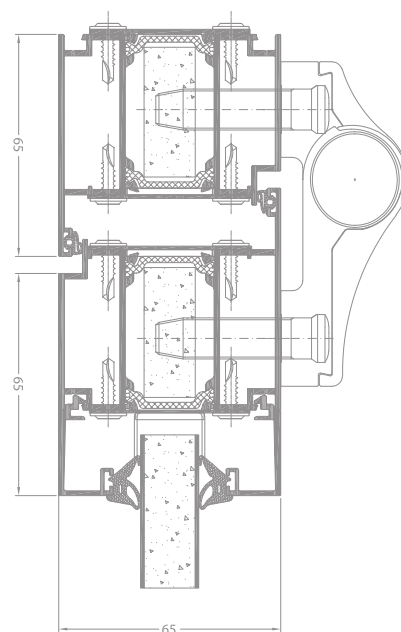

FR65 door section

TECHNICAL SPECIFICATION

| SYSTEM | MATERIAL | DEPTH OF FRAME | DEPTH OF LEAF | GLAZING RANGE | MAX. SIZE OF FIX GLAZING | MAXIMUM DOOR SIZES |
|--------|----------------------|----------------|---------------|---------------|--------------------------|--|
| FR65 | aluminium / polyamid | 65 mm | 65 mm | 17-46 mm | EI30: 4930 x 3100 mm | single sash door EI30: 1450 x 2500 mm double sash door EI30: 2690 x 2500 mm |