

## MONORAIL

## MONORAIL



Monorail – option of the Ultraglide system. At least one fixed component (glazing) in the structure is the characteristic feature of the system. A system featuring improved thermal performance, used to design sliding and lift-sliding structures.

# MONORAIL

Monorail – option of the Ultraglide system. At least one fixed component (glazing) in the structure is the characteristic feature of the system. A special structure of the frame makes it possible to increase the clear opening relative to the fixed component. The system features improved thermal performance.

## Characteristics of construction:

- maximum leaf weight: 400 kg
- single-rail frame
- possible structure variants:
  - 2-component (sash + fix)
  - 3-component (sash + fix + sash)
  - 4-component (2 sashes + 2 fixes)
- optional to use glazing from the outside, which makes it possible to use large-size, heavy infills

There is possibility of use Flyscreen system (Flyscreen – fly screens are a practical and an extremely functional protection against insects).

Wide range of colours – RAL palette (Qualicoat 1518), texture colours, Aliplast Wood Colour Effect (wood-like colours), Aliplast Loft View – colours imitating stone surfaces (Qualideco PL-0001), anodised colour (Qualanod 1808), bi-colour.

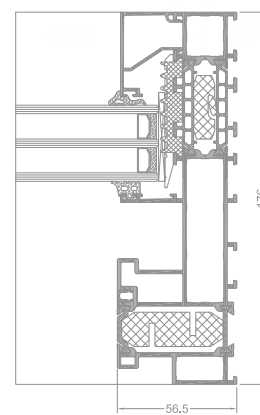

MONORAIL cross section

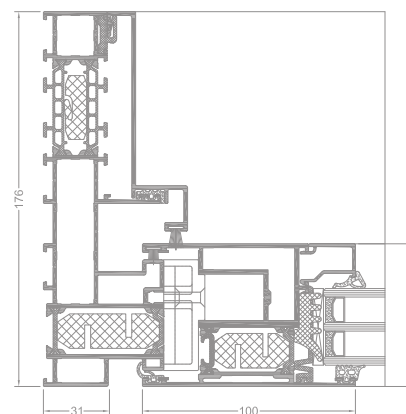

MONORAIL cross section

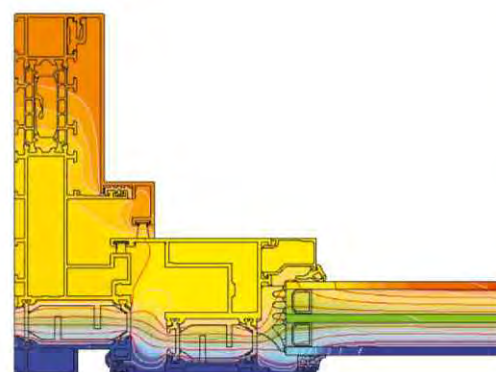

distribution of isotherms for frame with sash composition in MONORAIL system (UG 611 + UG 820)

## TECHNICAL SPECIFICATION

SYSTEM	DEPTH OF FRAME	DEPTH OF LEAF	GLAZING RANGE	ACOUSTIC	WEIGHT OF LEAF	MAXIMUM DOORS SIZES
MONORAIL	176 mm / 67 mm	14-52 mm fix 12-72 mm	43 (-2,-6) dB	to 250 kg (sliding option) / to 400 kg (lift-sliding option)	3850 x 2550 mm	

## PERFORMANCE

SYSTEM	THERMAL INSULATION Uf *	AIR PERMEABILITY	WINDLOAD RESISTANCE	WATERTIGHTNESS
MONORAIL	Uf from 0,93 W/m <sup>2</sup> K	Class 4; EN 12207	C5 (2000 Pa); EN 12210	E750 (750 Pa); EN 12208

\* Thermal insulation is dependent on a combination of profiles and thickness of the filling.